

Page 275, 276 (February Term, 1821) John Ewing vs Joseph Garrison action of trespass for destroying timber...  
aimed by plaintiff on tract described in 277, 278, 79, 80, 81 East.

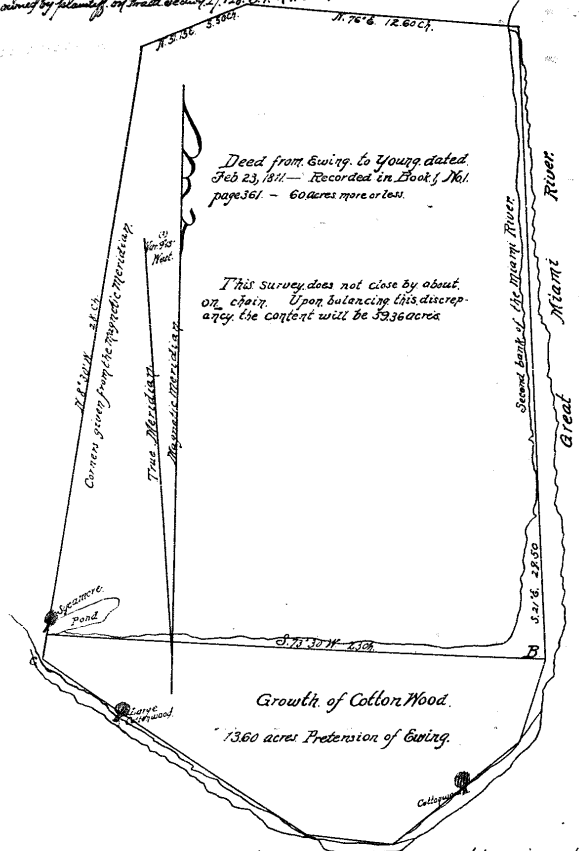

Deed from Ewing to Young dated Feb 23, 1811 - Recorded in Book 1, 161, page 361 - 60 acres more or less.

This survey does not close by about 0.7 of a cent. Upon balancing this discrepancy, the content will be 3336 acres.

Commiss. Nicholas Adams... Survey of on this disputed terrain...  
The beginning containing 13.60 acres Surveyed by order of Court dated 1821, Jan'y 20, by Thos. Henderson, Surveyor...  
Surveyor's Return... 6320 damages, & costs of suit.

Vol. 75-76 p. 451-452 (February Term 1808) Partition of 95 acres...  
John Holes Farm containing 6 7/8 Acres...  
Surveyed by Abraham... March 7, 1810.

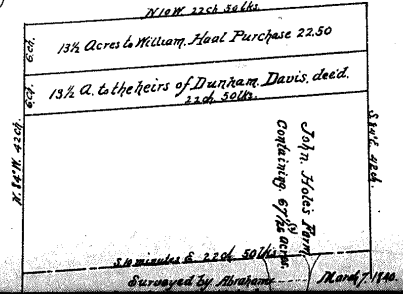

Page 482, 487 (Feb. Term, 1824) Partition of estate of Perry Nichols decd.

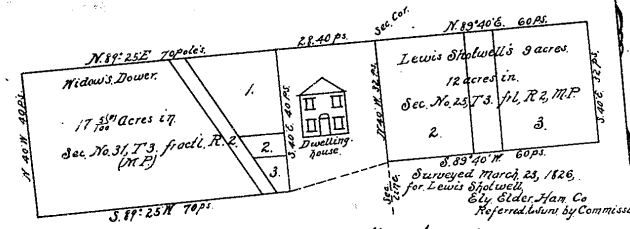

Polishing, Publication, &...  
Commencing at S. E. cor of the 17<sup>th</sup> corner...  
Unit 25...  
Unit 2...  
Unit 3...

Page 477-506 (Feb Term, 1824) Sale of estate of John Cunningham decd...  
East of said road on the bank of the Miami River...  
from which a black walnut 2 1/2 in diam...  
Report of Commissioners Survey of John Cunningham...  
from which a hickory 7 in diam...  
a black walnut 3 in diam...  
a large sycamore...  
a large white oak...  
to the place of beginning...  
Surveyed April 4, 1824. Surveyed by Thos. Henderson, S. C. O.

