

Vol 65 page 21252 (100) Petition for Partition of estate of Joseph Ferris dec'd Filed Sept 26, 1835 by Mary Ferris (late Mary Ferris) & husband John Ferris 67 1/2 acres in N.W. 1/4 Sec 21 as expressed in the 17th of Columbia Township 5th Feb R. 2. W. P. being the same as was set off to the said heirs by Commissioners appointed to make partition between them and their father who was a tenant in common of said premises with the said Joseph Ferris dec'd a plat of which partition is recorded in the Clerk's office and of which a copy is here attached marking (a) also a tract beginning 24 poles E. of the N.W. cor. of 3rd Survey No. 7. thence parallel with W. line of said Sec. 21 to the Little Miami thence with the bank of said river till it strikes the S. line of 1st Sec. 15 thence with said line to the 1st cor. of said Sec. 15 thence N. with the Sec. line to land belonging to the heirs of John Caste dec'd and is bounded on the N. by the heirs of said Caste dec'd in part & part by land of Thomas Hutchings, Jesse Cooper & Sec. 16 lands belonging to the heirs of David Muck more being a part of 1st Sec. 7. 2nd 1/4 Sec. 14. 1st 1/4 Sec. 12. Containing 516 acres more or less also The N. 1/4 of Ferris taken off of Sec. 9. 2nd 1/4 Sec. 2. W. P. beginning on the N. line of said Ferris thence N. 53 poles 1100 poles. Contain 35 acres 15 poles more or less also 11 acres purchased of Laban B. Felt by Joseph Ferris & James Ferris & James Ferris as set off to said heirs of Joseph Ferris on the plat of partition made by Commissioners appointed by the Court of Common Pleas of said County of Hamilton at day Term 1833 in the suit of Joseph Ferris vs. others vs. said Ferris, others being part of a tract of 30 acres situate in Sec 15 & 21 2nd 1/4 Sec. 2. W. P. which 30 acres is divided as follows: Beginning at N.W. cor. of Sec. 21: thence S. 1/2 E. 3 ch 12 poles thence N. 79 1/2 E. 14 ch 53 poles thence S. 1/2 E. 6 ch 88 poles thence N. 79 1/2 E. 6 ch 25 ch 91 poles thence N. 11 W. 10 ch thence S. 84 1/2 W. 3 ch 39 poles to the beginning containing 30 acres 1 rood 30 poles also lands in Hamilton County situated between the Cincinnati Columbus & Worcester Turnpike on the N. W. line belonging to Charles Laidner & others the Little Miami second division of lots on the S. and Elizabeth Ferris lands on the E. and included by line commencing at a stone in the S.E. cor. of said tract as shown from which a blue ash 9 in b. 7. 20 in 28 the N. W. line running thence N. 0 3/4 W. 26 ch 78 poles to the center of the Turnpike thence with said Turnpike S. 62 1/2 W. 31 ch 74 poles thence S. 56 W. 4 ch 75 poles thence S. 57 1/4 W. 47 ch 54 poles thence S. 35 1/4 W. 2 ch 80 poles to Sec. line thence with said line N. 87 1/2 E. 3 ch 71 to the top of Red Bank thence along the top of the down N. 26 1/2 E. 2 ch 9 poles thence N. 33 1/4 E. 7 ch 57 poles thence N. 47 1/2 E. 5 ch 56 poles thence descending the bank east 6 ch 50 poles to the Little Miami thence leaving said river N. 70 poles to a stone thence N. 70 1/2 E. 38 ch 61 to a stone thence N. 57 1/2 E. 9 ch 97 poles to the place of beginning containing 110 acres 2 rods 11 poles. These premises the river are here by made over to remain subject to the same as a privilege of a private road 20 ft in width leading from the bottom or 25 divisions of lots to the Turnpike as marked upon the Plat and fully described in the way in them for the equal benefit & accommodation of the said heirs to said Ferris & Ferris as set off Lot 76.4 in the 1st Division of lots bounded as follows commencing at a stone in the N.W. cor. of said Lot 76.4 from which a Sugar tree 20 in b. 2 29 in 40 poles & a Buckeye 15 in N. 57 E. 45 poles running thence N. 50 E. 32 ch 83 l. passing a stake in the N.W. line of the Turnpike to or near the center of said Turnpike thence with the same N. 50 E. 1 ch 46 l. thence N. 62 1/4 E. 6 ch 84 l. thence leaving said Turnpike & passing a stake in the N.W. line thence N. 35 3/5 W. 40 ch 75 l. to a stone thence S. 10 ch 81 l. to a stone in the South Bank of East Duck Creek from which a Red Oak 12 in b. 7. 44 E. 23 ch 1 - a Sugar tree 21 in b. 42 1/2 E. 25 poles thence down with the creek S. 17 W. 4 ch 50 l. to a stake thence S. 31 W. 3 ch. to a stake thence N. 19 W. 15 poles to place of beginning containing 35 acres 3 roods 20 1/2 poles also Lot 76.5 in the 2nd Division of lots commencing at a stone in N.E. cor. of said Lot thence N. 6 ch 67

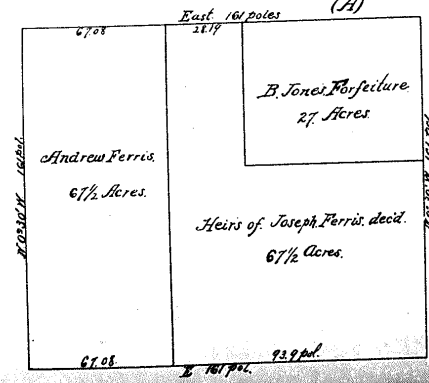

to a stone thence N. 30 3/4 E. 22 ch 11 l. to water mark of the Little Miami and passing a stone placed in the bank of the bank of said river thence up 7 poles with the river S. 65 1/2 E. 6 poles thence S. 77 1/4 E. 6 ch 78 poles thence leaving the river & passing a stone placed in the bank of the bank of said river thence N. 23 ch 45 l. to the place of beginning containing 15 acres 38 poles also Lot 76.1 in the 3rd Division of lots commencing at a stake in the N.W. cor. of said Lot running thence

0' 35 7/8 5 ch. to a stake thence S. 89 3/5 E. 12 ch 25 l. to the County Road thence with said Road N. 0 35 E. 5 ch thence leaving said Road N. 89 3/5 W. 13 ch 25 l. to place of beginning containing 6 acres 2 rods 20 poles also Lot 76.8 in 3rd Division of lots commencing at a stake in N.W. cor. of said Lot running thence S. 0 35 W. 6 ch 50 l. to a stake thence S. 89 3/5 E. 3 ch 31 1/4 l. to a stake N. 0 35 E. 6 ch 50 poles to a stake thence N. 89 3/5 W. 3 ch 31 1/4 l. to place of beginning contain 2 acres 2 1/2 poles also Lot 76.1 as exhibited on Plat (a) and commencing at a stake in N.E. cor. of said Lot running thence N. 89 1/2 W. 5 ch. to a stake thence N. 1 E. 5 ch. to a stake thence S. 89 1/2 E. 5 ch. to a stake thence N. 1 W. 5 ch. to place of beginning containing 2 acres & 2 roods. To Mary Ferris as set off Lot 76.5 of the 1st Division of lots commencing at a stone in the South Bank of the East Duck Creek from which a Sugar tree 20 in b. 29 in 40 l. & a Buckeye 15 in N. 57 E. 45 poles running thence N. 19 W. 6 ch 85 l. to a stake thence S. 3 E. 7 ch 50 l. to a stake thence N. 10 W. 7 ch 07 l. to a stone from which a Honey Locust tree b. 7 7 1/2 E. 18 l. & a Red Oak 3 in b. 6 5 3/4 E. 7 ch 50 l. to a stake thence N. 10 W. 7 ch 07 l. to the center of the Turnpike and passing a stake in the N.W. line of said Turnpike E. 20 poles thence S. 66 1/2 E. 22 ch 10 l. to or near the center of the Turnpike & passing a stake in the N.W. line thence with the same N. 89 1/2 E. 6 ch 75 l. thence N. 56 E. 3 ch 29 l. thence leaving the Turnpike & passing a stake in the N.W. line thence N. 47 1/2 W. 32 ch 83 poles to place of beginning Cont. 35 acres 2 rods 5 poles also Lot 76.3 in 3rd Division of lots commencing at a stone in N.E. cor. of said Lot and running thence N. 70 W. 20 ch 2 l. to a stone thence S. 79 ch. to the Little Miami thence up with said river S. 58 1/2 E. 3 ch 50 l. thence N. 28 1/4 E. 3 ch 94 l. thence S. 33 E. 14 ch 24 poles thence N. 67 ch 89 l. thence leaving the river and passing a stone in the line in the bank of said river N. 34 W. 29 ch 17 l. to the place of beginning containing 27 acres 2 R. 4 Poles also Lot 76.2 in the 1st Division of lots commencing at a stake thence N. 89 1/2 W. 7 ch 05 to a stake thence S. 12 ch 57 W. 16 ch 43 l. to a stake in the N.W. cor. of 8 poles Ferris thence N. 54 1/2 W. 10 ch 10 l. to a stake in the N.W. line of the Turnpike and passing a stake in the N.W. line of said Turnpike thence with the same N. 62 1/4 E. 6 ch 84 poles thence N. 63 in 1st Division of lots commencing at a stone in the N.W. cor. of a Lot set off to Sarah Ferris in set off Lot 76.3 in the center of the Turnpike and passing a stake in the N.W. line of said Turnpike thence with the same N. 62 1/4 E. 6 ch 84 poles thence leaving the Turnpike & passing a stake in the N.W. line thence N. 53 1/2 W. 37 ch. to a stone in the sec. line thence with said line N. 89 1/2 W. 10 ch 46 l. to the 1/2 Sec. cor. thence S. 1 ch 49 l. to the place of beginning containing 25 acres 3 R. 2 1/2 Poles also Lot 76.6 in the 2nd Division of lots commencing at a stone in N.E. cor. of said Lot running thence N. 7 ch 57 poles to a stone thence S. 0 34 E. 17 ch. to the Little Miami and passing a stone in the line on the bank of said river thence up the same S. 58 1/2 E. 4 ch 66 poles thence S. 66 1/2 E. 4 ch 2 l. thence leaving the river & passing a stone in the bank N. 0 34 W. 22 ch 11 l. to the place of beginning containing 15 acres 1 rood 4 poles also Lot 76.3 in the 3rd Division of lots commencing at a stake in N.E. cor. of said Lot running thence N. 89 3/5 W. 13 ch 25 l. to a stake thence S. 89 3/5 E. 13 ch 25 l. to the County Road thence with said Road N. 0 35 E. 5 ch. to the place of beginning 6 acres 2 R. 20 P. also Lot 76.7 in the 3rd Division of lots commencing at a stake in the N.E. cor. of said Lot thence N. 89 3/5 W. 3 ch 31 1/4 l. to a stake thence S. 0 35 W. 6 ch 50 l. to a stake thence S. 89 3/5 E. 3 ch 31 1/4 l. to a stake thence N. 0 35 E. 6 ch 50 l. to place of beginning contain 2 acres 2 1/2 Poles To Charles Ferris Lot 76.2 in the 1st Division commencing at a stone in the Sec. line in the N.W. cor. of said Lot & running thence with the E. line of a Lot set off to Jackson Ferris S. 33 E. 37 ch 39 poles to or near the center of the Turnpike and passing a stake in the N.W. line of said Turnpike thence with the same N. 67 1/2 E. 8 ch 30 l. thence leaving the Turnpike & passing a stake in the N.W. line thence N. 70 1/2 W. 15 ch 17 l. to a stone in the sec. line thence N. 89 1/2 W. 15 ch 17 l. to place of beginning containing 35 acres 3 P. rods 25 1/2 Poles also Lot 76.1 in the 2nd Division of lots commencing at a stone in the N.E. cor. of said Lot running N. 57 1/2 W. 7 ch 11 l. to a stone thence S. 0 34 E. 32 ch 83 l. to a stone thence N. 0 34 W. 27 ch 69 poles to place of beginning containing 16 A. 2 R. 2 P. also Lot 76.2 in 3rd Division of lots commencing at a stake in N.E. cor. of said Lot running thence N. 89 3/5 W. 13 ch 25 l. to a stake thence S. 0 35 W. 5 ch. to a stake thence with the N. line of a Lot set off to the same Ferris S. 89 3/5 E. 13 ch. to the County Road thence with said Road N. 0 35 E. 5 ch. to place of beginning containing 6 acres 2 R. 20 P. also Lot 76.6 in 3rd Division of lots commencing at a stake in the N.E. cor. of said Lot running N. 89 3/5 W. 3 ch 31 1/4 l. to a stake thence S. 0 35 W. 6 ch 50 l. to a stake thence S. 89 3/5 E. 3 ch 31 1/4 l. to a stake thence N. 89 3/5 E. 6 ch 50 l. to place of beginning contain 2 acres 2 1/2 Poles also Lot 76.2 as exhibited on Plat (a) commencing at a stake in N.E. cor. of said Lot running thence N. 89 1/2 W. 5 ch. to a stake thence S. 89 1/2 E. 5 ch. to a stake thence N. 1 W. 5 ch. to the place of beginning containing 2 acres & 2 roods. To James Ferris as set off Lot 76.4 in the 1st Division of Lots commencing at a stake in the N.W. bank of said Creek from which a yellow oak on the E. bank of said Creek b. 7 7 1/2 E. 18 l. & a water Elm tree b. 7 7 1/2 E. 18 l. thence down with the N. bank of said Creek S. 21 1/2 W. 4 ch 70 l. thence leaving the creek West 70 ch 67 l. to a stake in the Sec. line from which a Sugar tree b. 5 5 1/2 W. 16 poles & an Elm tree b. 10 2 1/2 W. 67 poles thence S. 0 25 E. 17 ch 63 l. to Sec. cor. thence with Sec. line N. 89 1/2 E. 22 poles to the center of Turnpike thence with said Turnpike N. 53 1/2 E. 22 ch 80 poles thence N. 73 1/2 E. 24 ch 85 l. thence leaving the Turnpike & passing a stake in the N.W. line thence with said Turnpike N. 53 1/2 E. 22 ch 80 poles to the place of beginning containing 65 ac. 2 R. 8 poles also Lot 76.3 in the 2nd Div of Lots commencing at a stone in N.E. cor. of said Lot running thence N. 89 1/2 W. 3 ch 31 1/4 l. to a stone thence S. 0 34 W. 20 ch 81 l. to place of beginning containing 14 A. 2 R. 36 P.