

Vol. 142 p. 262-267 (May Term 1830 - 1832) Partition of Estate of Samuel Kitchell said to wit. Beginning at a small Elm & Sycamore on the E. bank of Sand Creek on the N. bound line of Sec. 16. T. 4. R. 2. M. 1. Thence S. 85.25' G. with the Sec. line 75 ft. to a stone said to be the corner of a certain 10 Acre lot. Thence S. 15' E. 21 7/8 ft. Thence S. 85' 45" W. 31 1/2 ft. to a knotty white Elm. Thence S. 68 ft. W. 45 ft. to a post. Thence 75' 30" W. 85 ft. to a stake. On the W. bank of Sand Creek thence 335.05 ft. Thence N. 34.25' E. 26 ft. to place of Beginning. also 19 Acres, 2 Rods 19 Cts. off the N. side of Farm Lot No. 2. also 2 Rods in N.W. Cor. of Farm Lot No. 2 both of the last said tracts being in Sec. 16. before laid also in same Sec. 16. R. the first Division or 1/2 of Farm Lot No. 2. Another description reads "in" instead of "or" Commencement set off as Down to Judith Kitchell Lot or Lot 1 on Sec. 16. Lot 2. on Lot 15. To Christopher Kitchell Lot 8 on Plat A being 1/2 Acres encumbered by Dower 5 1/2 A. A minor number also on Plat B. Lot 15. being 5 1/2 Acres free and 290 Acres encumbered by Dower. To Esther Maria Kitchell Lot 10. Plat A and Lot 13. Plat B. down encumbered free (See Plat) To Eliza Kitchell Lot 11. Plat A. Lot 4. Plat B. (See Plat) To Charles Kitchell Lot 17. Plat A and Lot 16. Plat B. (See Plat).

B. Tract on Sec. 16, T. 4, R. 2.

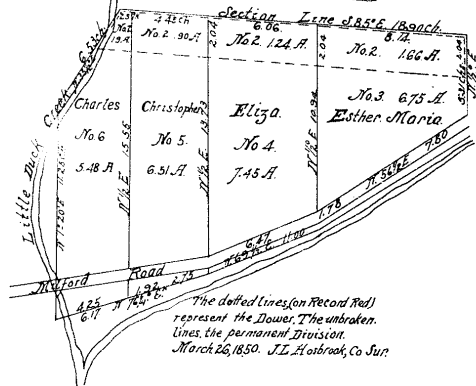

A 20 ft. alley from the N.W. cor. of Lot No. 10 to Sec. 16 North to the N.W. corner of the premises above the ends of Lot 7. 1849. it hereby reserved from the foregoing assignment for the use of all the owners of the houses as a Road. For a more particular Description of the Lots see the attached Plat of survey made by J. L. Horbrook and dated March, 26th 1830.

Solomon Green }
 Amy Stewart } Commission
 Joseph Ludlow }

Vol 101 p. 315-325 (316) (June 5, 1842). Nicholas Longworth Foreclosure of Mortgage given to him by Chas. S. Clenden on premises adjoining Cincinnati to wit 115 ft. of ground on N. side of Hamilton St. Beginning 112 ft. E. of N. line of Columbus Bradley, Dublin drive thence running E. westerly 115 ft. on N. line of Hanthwaite thence N. westerly on line of said tract thence south 110 ft. thence 115 ft. to line of Columbus Bradley Dublin drive.

This Plat exhibits Sheriff's Subdivision of the premises above of the premises sold by Lots as subdivided by Sheriff June 24, 1842. to Nicholas Longworth.

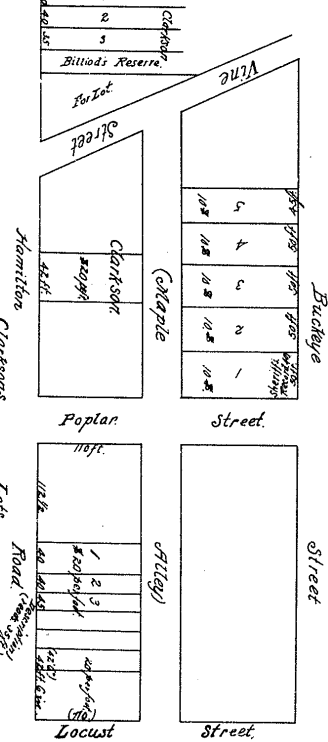

thence south 110 ft. to the Beginning also on Hamilton St. a lot commencing 170 ft. of the Junction of Poplar & Hamilton Streets thence East on N. side of Hamilton Street 115 ft. thence South on a line of Poplar St. to side of Maple alley, thence westerly along side of said alley to a point 22 ft. 6 in. thence westerly to the Beginning point on N. side of Hamilton Street also 22 ft. 6 in. side of Buckeye St. Beginning at Junction of Buckeye & Poplar St. running N. & South on side of Buckeye St. 12.05 ft. thence South parallel to Poplar St. to side of Maple alley thence westerly on N. side (S. 1) of Maple alley to the Junction of Maple Alley & Poplar St. thence N. westerly along Poplar St. to Beginning 115 ft. on Plat 74, p. 325. 1. Copy of Mortgage used along with side. 2. " " " on North side of Maple Alley get summary etc. or. 3. Copy of mortgage used on South line. This Plat exhibits Sheriff's Subdivision of the premises all of the premises sold by Lots as subdivided by Sheriff June 24, 1842. to Nicholas Longworth.

of the parallel 1/4 mile to a forfeiture of said said Section, thence east to the which being the West Half of Containing 43 1/2 Acres. We the undersigned, Commissioners called J. C. Eversell, Surveyor to our assistance and after ascertaining the exact amount of land examined, we have made the following division to wit: Lot No. 1. Containing 14 Acres, with improvements thereon set off for the widow Dower. Lot No. 2. Containing 7 1/2 Acres. We set off to Edward C. Cook. Lot No. 3. Containing 7 1/2 Acres. We set off to Herbert L. Reed. Lots No. 4 & 5. Containing 20 1/2 Acres we set off to Eliza Davis wife of Josiah Davis. For location of the above described Lots see Plat attached June 21, 1831. Joseph Jackson, M. C. Williams, B. A. Head, Commissioners. Lot No. 1. Beginning at N.W. Cor. of the Field, thence S. 10 W. 8 ch. 51 lls. thence East 16.33 ch. thence N. 1° E. 18.51 ch. to N. line of Sec. thence West 16.33 to place of Beginning. Lots Nos. 2 & 3 Beginning at the S.E. Cor. of the Widows down thence West 16.61 ch. thence S. 1° N. 16.91 ch. to the center of the Old Colerain Road, thence with the center of said Road to the E. line of said Lewis estate thence N. 1° E. 17.91 ch. to place of Beginning Containing 15 Acres. Lot No. 4. Beginning on the Center of said Road at S. E. Cor. of Lot No. 3. thence N. 1° E. 16.91 ch. thence N. 7.72 ch. thence S. 1° N. 16.73 ch. to the center of said Road thence with the center of said Road to the place of Beginning containing 12.00 Acres. Lot No. 5 Beginning at the N.W. Cor. of a lot sold thence S. 1° 30' W. 6.72 ch. thence N. 12.09. thence N. 1° E. 8.06 ch. to center of thence with the center of said Road to the place of Beginning containing Acres

