

SUBDIVISION  
OF  
THE ANTHONY OEHLER TRACT

MADE IN CASE NO. 98843 HAM CO COMMON PLEAS

Leo Oehler plaintiff

vs

Amelia Roth et al defendant

Recorded October 4, 1898

in Plat Book No. 14 Page 42

John Hagerly, Recorder

REC. 12. 1898

HAM CO

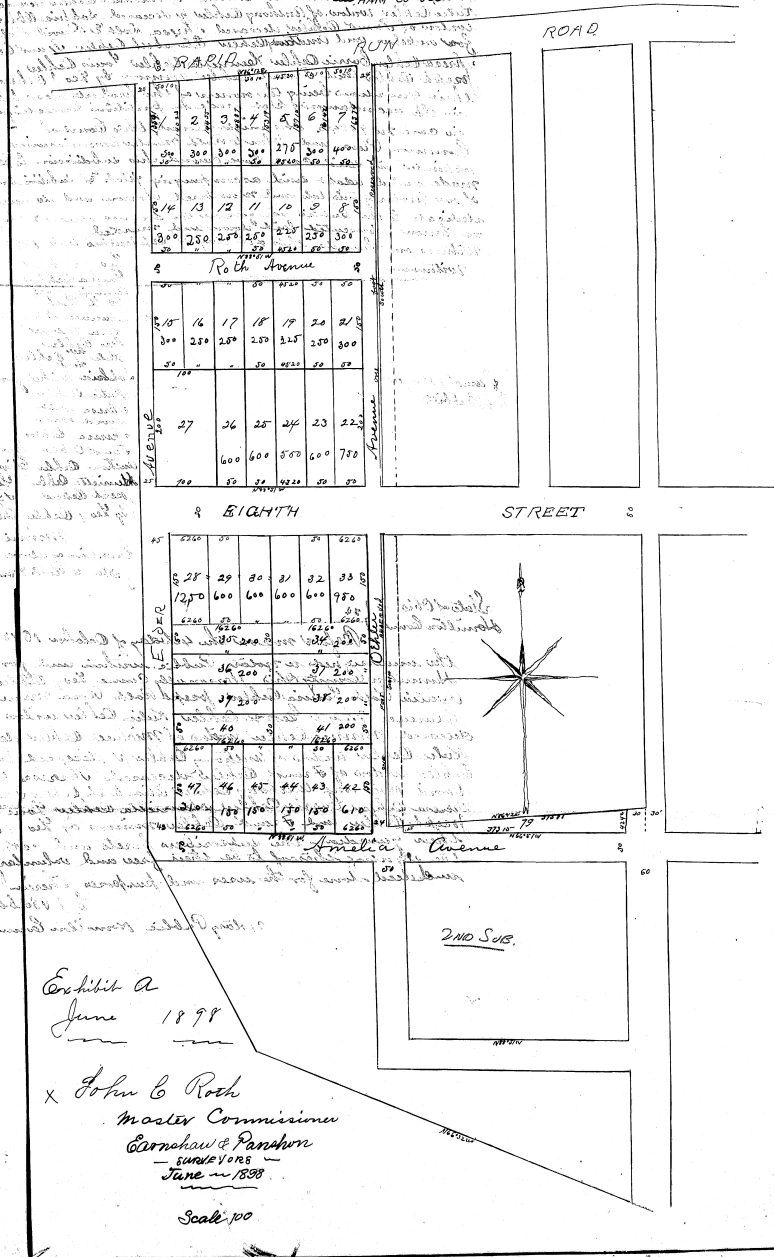

1	2	3	4	5	6	7
30	30	30	270	300	400	
1/4	1/2	1/2	1/2	1/2	1/2	1/2
300	250	250	250	250	250	250

Roth Avenue

15	16	17	18	19	20	21
300	250	250	250	250	250	300
27	26	25	24	23	22	
600	600	500	600	780		

EIGHTH STREET

28	29	30	31	32	33	34
1250	600	600	600	600	980	
36	35	34	33	32	31	30
40	39	38	37	36	35	34
47	46	45	44	43	42	41
2100	1800	1700	1700	1700	1700	1700

Exhibit A  
June 1898

x John C. Roth  
Master Commissioner  
Carrshaw & Parsons  
Surveyors  
June 1898

Scale 100

CRB-124

CASE NO. 98843  
THE PLAT ATTACHED TO PAGE NO. 496  
RECORD BOOK 299 IS MICROFILMED ON  
SPECIAL 35MM REEL FOR PLATS.

Lucille Steel  
Microfilm Operator