

Exhibit A

Plat

The land of John Nash NW 20 section
20 Township 4 Fractional Range 2 N.B.P. made
under the direction of the Commissioners in
case No. 6772 when the same was to be
called John Nash Estate Subdivision

BOOK 4
PAGE 290

I hereby certify that this plat is a correct
representation of the work done by me on the ground
Apr 14th 1883
Wm M. Ferris
Surveyor

1
2
3
4
5
6
7
8
9
10
11
12
13
14
15
16
17
18
19
20

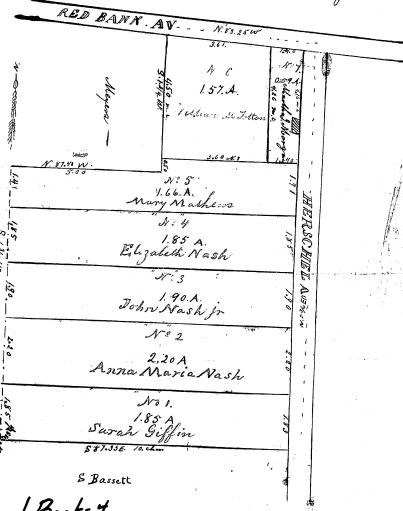

Record Book-4
Page 290

COB #2

CASE NO. 6772
THE PLAT ATTACHED TO PAGE NO. 290 IN
RECORD BOOK # 4 IS MICROFILMED ON
SPECIAL 35MM REEL FOR PLATS.

Luellen Steed
Microfilm Operator